

FACILITY PROGRAMMING AND SPACE PLANNING

MASTER PLAN

San Carlos Apache Tribe Detention Center

San Carlos, AZ

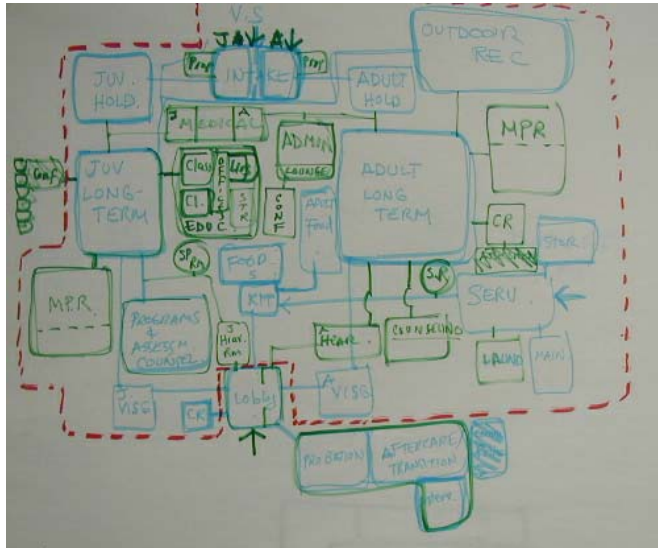

Built as a combination juvenile detention center and adult jail, the San Carlos Apache detention center will provide prevention, detention, intervention and rehabilitation functions. The facility will replace the Tribe's current adult jail and become its first juvenile detention center. Seen only as a "last resort", the center will function as a part of a new comprehensive justice system designed to address increasing crime rates mostly related to alcohol and substance abuse.

Services provided in this project included:

- Population analysis
- Needs assessment for required bedspace
- Functional narrative
- Operational space program
- Program plan for service delivery
- Design reviews

Total Construction Cost: \$10,800,000

Size: 108 adults and 48 Juveniles

Use: Juvenile Detention and Adult Jail

Owner: San Carlos Apache Tribe